

GM-3310



Features

- Ceiling Speaker with round front grill
- 11 W loudspeaker, transformer 100 V
- For background music and speech reproduction

Specifications

Loudspeaker system	1-way, tweeter dome
Nominal noise power 100 V	1.5/3/6 W
Nominal impedance 100 V	6667/3333/1667 Ω
Sensitivity (1 W/1 m)	94.1 dB
Maximum SPL (6 W/1 m)	101.9 dB
Frequency range (-10 dB)	77-20'000 Hz
Coverage angle (-6 dB)	H 180°/180°/135°/70°
(0.5/1/2/4 kHz)	V 180°/180°/135°/70°
Dimensions (Ø/Depth)	226 mm/80 mm
Cutout	Ø 196 mm
Weight	0.9 kg
Color	White
Temperature range	-20 °C to ~45 °C
Protection	IP44
Measurement environment	Half-space free-field

Electrical connection

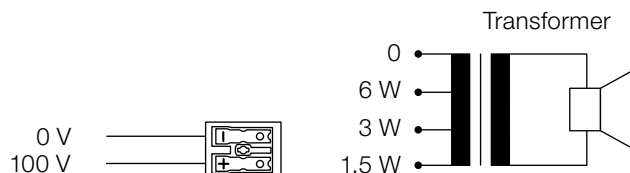

Certificates

EN 60268-5

Ordering information | Accessories

GM-3310	Loudspeaker 100 V
GM-3336	Housing
Art.-N° 546	Spring steel clip (PU 1 pc) 4 units for ceiling installation required if thickness < 8 mm
Colors	NCS or RAL available on request

Dimensions and fitting (measuring in mm)

With housing GM-3336

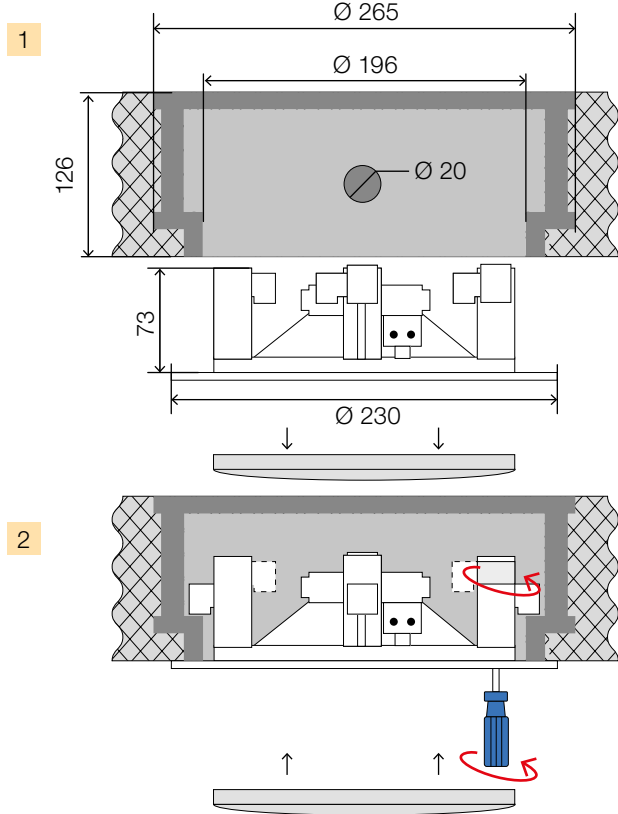

With suspended ceiling

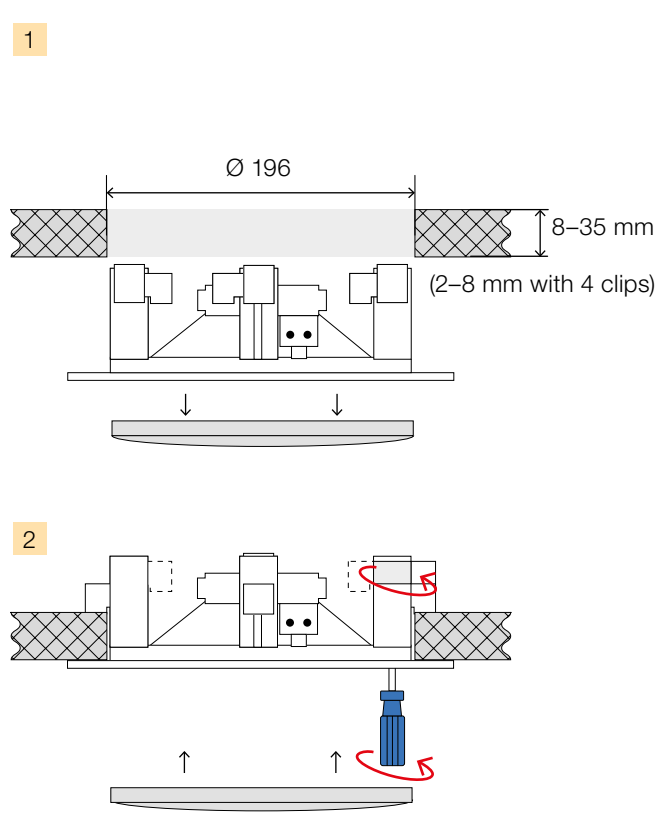

Frequency response | Polar plot

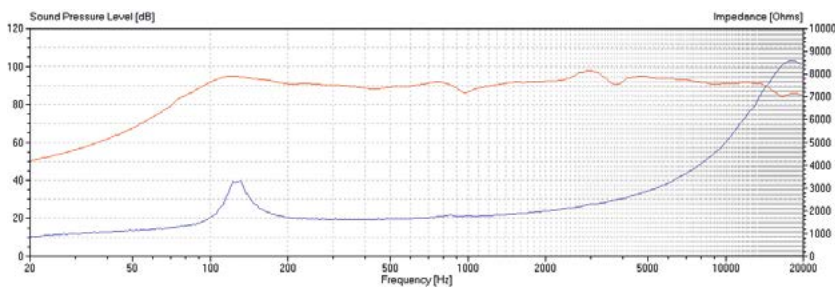

Horizontal

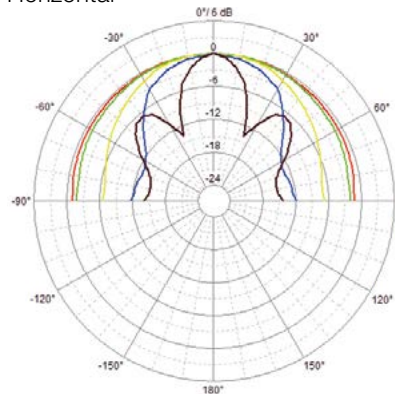

- 500 HZ
- 1 kHz
- 2 kHz
- 4 kHz
- 8 kHz

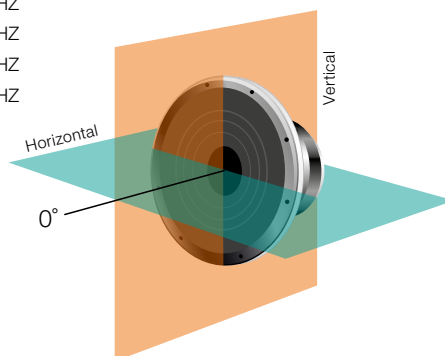

Vertical

