

# GM-3313-EV



## Features

- Ceiling speaker with round front grill
- 8 W loudspeaker, transformer 100 V
- EV-Version with ceramic terminal and thermal fuse – no short circuit in case of fire!
- For background music and speech reproduction

## Electrical connection

black = 0 V | blue = 100 V

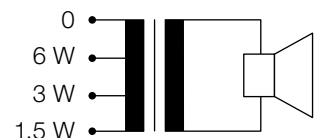
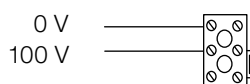

## Specifications

Loudspeaker system	1-way, tweeter dome
Nominal noise power 100 V	1.5/3/6 W
Nominal impedance 100 V	6667/3333/1667 Ω
Sensitivity (1 W/1 m)	92.6 dB
Maximum SPL (6 W/1 m)	100.4 dB
Frequency range (-10 dB)	76 – 20'000 Hz
Coverage angle (-6 dB)	H 180°/180°/110°/75°
(0.5/1/2/4 kHz)	V 180°/180°/110°/75°
Dimensions (Ø/Depth)	230/77 mm
Cutout	Ø 196 mm
Material	ABS 765A housing
Weight	0.9 kg
Color	White
Temperature range	-20 °C to ~45 °C
Protection	IP44
Measurement environment	Half-space free-field

## Certificates

EN60268-5

## Ordering information | Accessories

GM-3313-EV	Loudspeaker as EV-Version
GM-3336	Housing
Art.-N° 546	Spring steel clip (PU 1 pc) 4 units for ceiling installation required if thickness < 8 mm
Colors	NCS or RAL available on request

**Dimensions and fitting (measuring in mm)**

With housing GM-3336

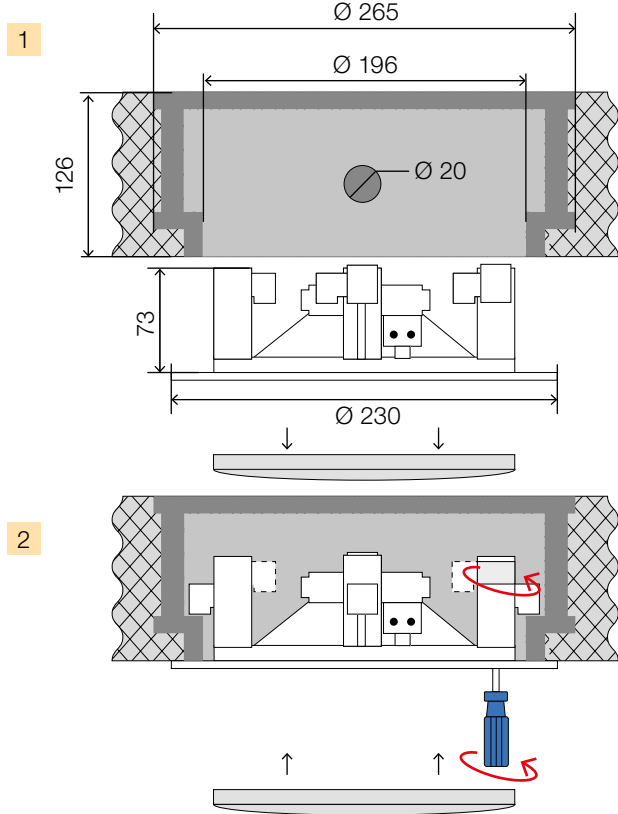

With suspended ceiling

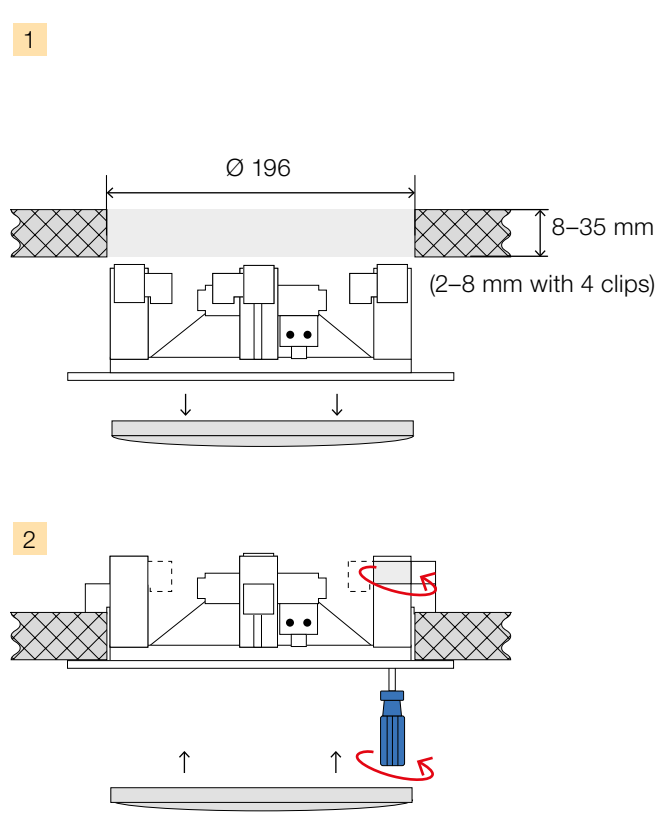

**Frequency response | Polar plot**

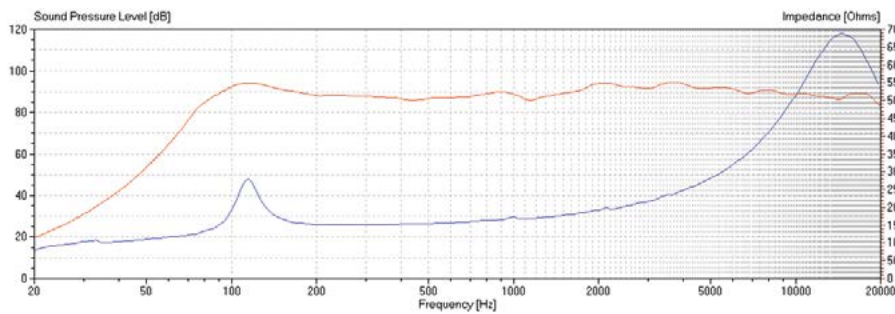

Horizontal

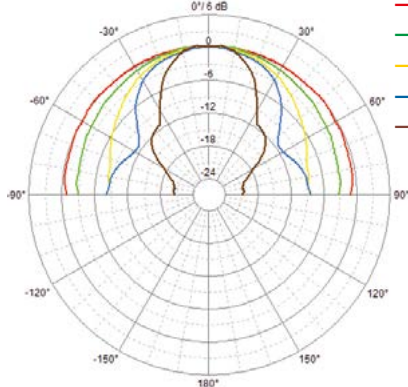

- 500 HZ
- 1 kHz
- 2 kHz
- 4 kHz
- 8 kHz

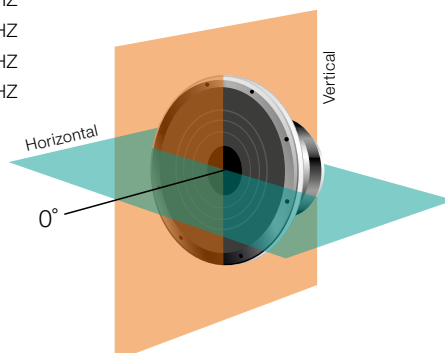

Vertical

