

# GM-3860-EN5424



## Features

- Ceiling speaker 2-way compact system with bass reflex port
- The 2-way compact system provides a very good music and voice reproduction

## Specifications

Loudspeaker system	2-way
Nominal noise power 100 V	15 W
Nominal impedance 100 V	667 $\Omega$
Sensitivity (1 W/1 m)	94.5 dB
Sensitivity (1 W/4 m)	76.8 dB
Maximum SPL (15 W/1 m)	106 dB
Maximum SPL (15 W/4 m)	88 dB
Frequency range (-10 dB)	85–18'000 Hz
Coverage angle (-6 dB)	H 180°/180°/180°/180°
(0.5/1/2/4 kHz)	V 180°/180°/180°/180°
Dimensions (Ø/Depth)	280/180 mm
Cutout	Ø 250 mm
Material	ABS 757 housing
Weight	4.1 kg
Color	White RAL 9003
Temperature range	-20°C to ~45°C
Protection	IP44
Measurement environment	Half-space free-field

## Electrical connection

blue = 0 V | brown = 100 V  
3 pole ceramic clamp

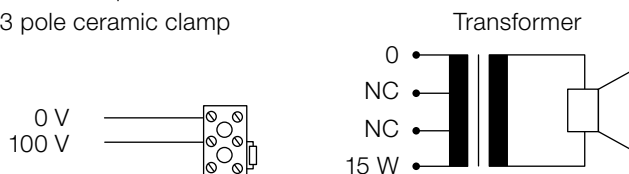

## Certificates

 1438
g+m elektronik ag Buererfeld 12, CH-9245 Oberbüren, Switzerland 14 1438-CPR-0386
EN 54-24:2008 Loudspeaker for voice alarm systems For fire detection and fire alarm systems for buildings Ceiling loudspeaker 15 W and accessories GM-3860-EN5424 Type A

## Ordering information | Accessories

GM-3860-EN5424	Loudspeaker accordance to EN 54-24
GM-3866	Housing
GM-3867	Ball protection grille
Colors	NCS or RAL available on request

**Dimensions and fitting (measuring in mm)**

With suspended ceiling

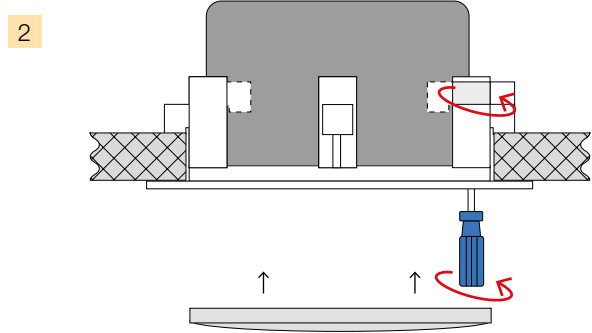
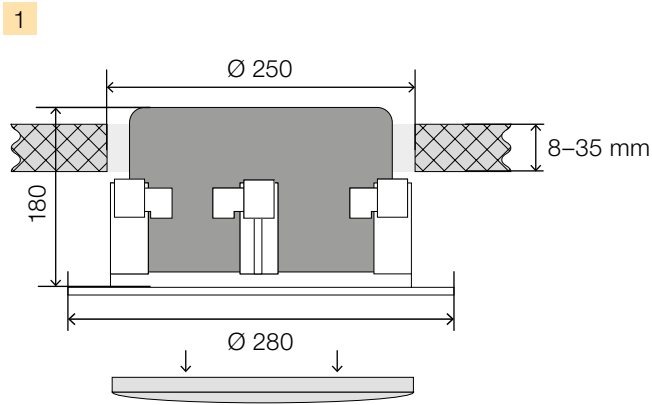

**Frequency response | Polar plot**

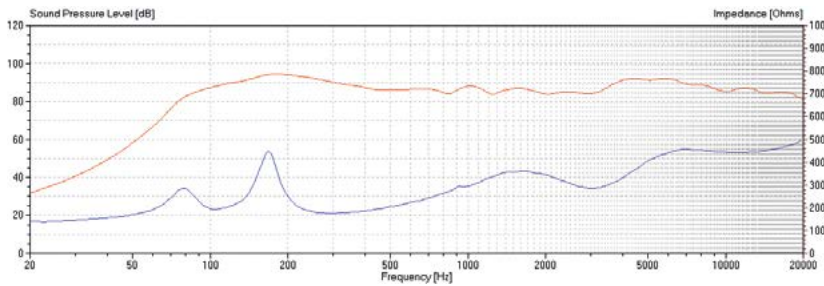

Sensitivity 100 Hz-10 KHz  
1/3 Oct. Pink noise total 1 W/4 m

Hz	62 dB	Hz	66 dB
100 Hz	57 dB	62 dB	64 dB
200 Hz	68 dB	61 dB	59 dB
400 Hz	62 dB	63 dB	60 dB
800 Hz	60 dB	66 dB	67 dB
1600 Hz	62 dB	63 dB	58 dB
3160 Hz	60 dB		
6300 Hz	67 dB		

Horizontal

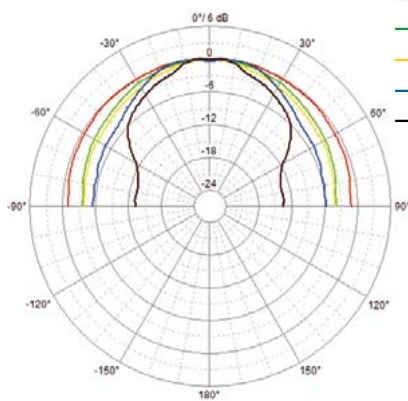

- 500 HZ
- 1 kHz
- 2 kHz
- 4 kHz
- 8 kHz

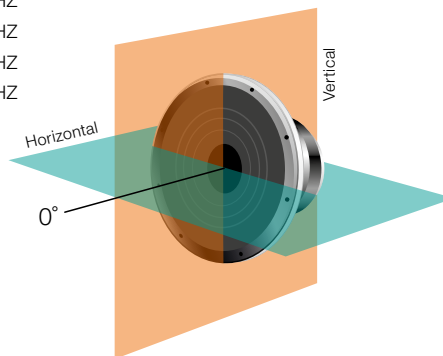

Vertical

