

GM-5600-7179-EN5424

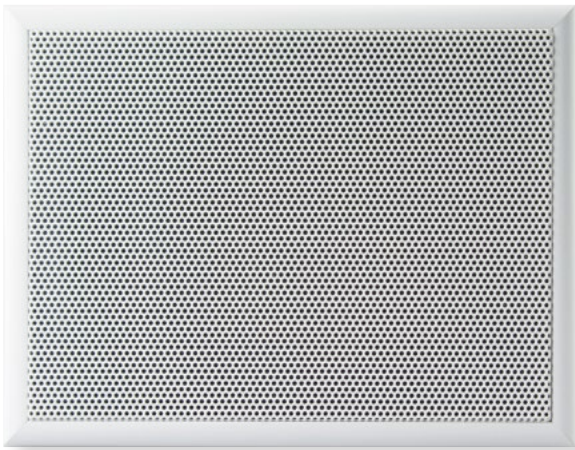

Features

- Rectangular cabinet speaker with MDF-wood housing
- 6 W loudspeaker, transformer 100 V
- Prepared cable feedthrough for simple snap and screw mounting
- For music and voice reproduction
- EN 54-24 certified speakers with GM-7179-Box for use with APS-180 LOOP

Specifications

Loudspeaker system	1-way
Nominal noise power 100 V	1.5/3/6W
Nominal impedance 100 V	6667/3333/1667 Ω
Sensitivity (1 W/1 m)	95.7 dB
Sensitivity (1 W/4 m)	79.9 dB
Maximum SPL (6 W/1 m)	103.5 dB
Maximum SPL (6 W/4 m)	87.6 dB
Frequency range (-10 dB)	170–20'000 Hz
Coverage angle (-6 dB)	H 180°/70°/110°/60° V 180°/80°/100°/50°
Dimensions (W × H × D)	192 × 252 × 82 mm
Material	MDF wood housing
Weight	1.9 kg
Color	White RAL 9003
Temperature range	-20°C to ~45°C
Protection	IP44
Measurement environment	Half-space free-field

Electrical connection

black = 0 V | blue = 100 V
3 pole ceramic clamp

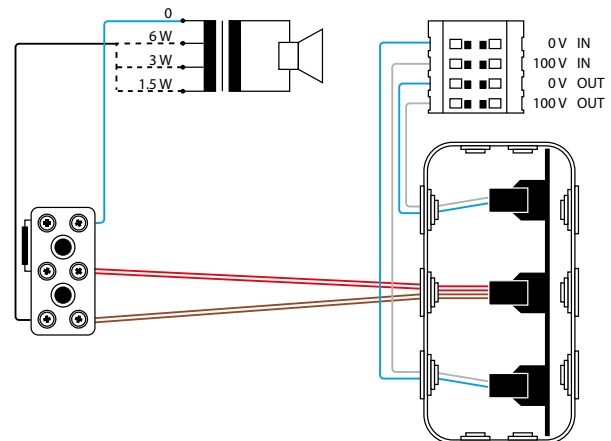

Certificates

- EN 54-24 (1438-CPR-0377) GM-5600-EN5424
- EN 54-17 (1438/CPD/0289) GM-7179-Box

Ordering information | Accessories

- GM-5600-EN5424 Loudspeaker in accordance to EN 54-24 with GM-7179-Box
- Colors NCS or RAL available on request

Dimensions and fitting (measuring in mm)

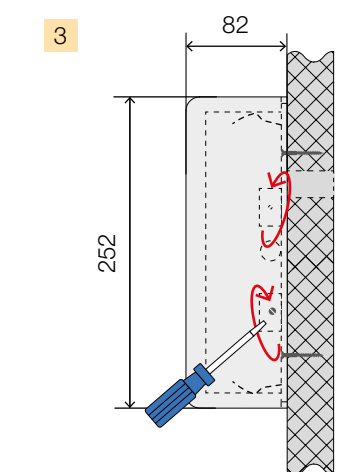
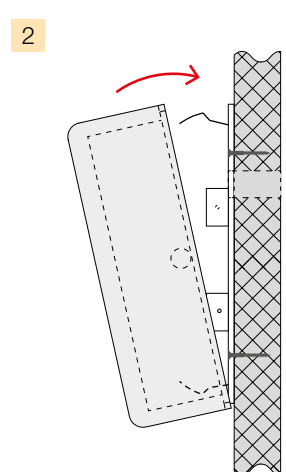
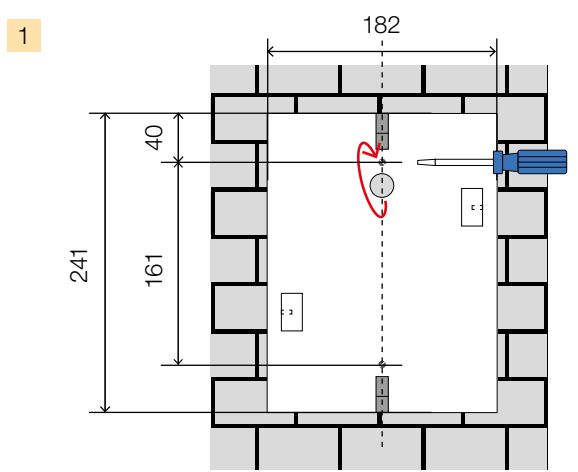
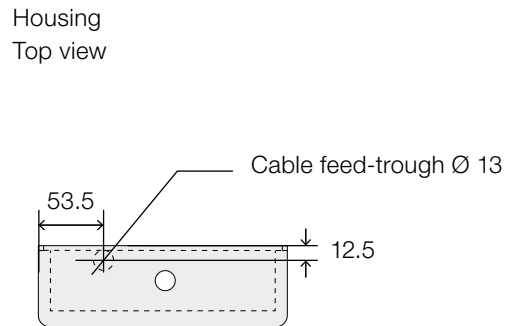
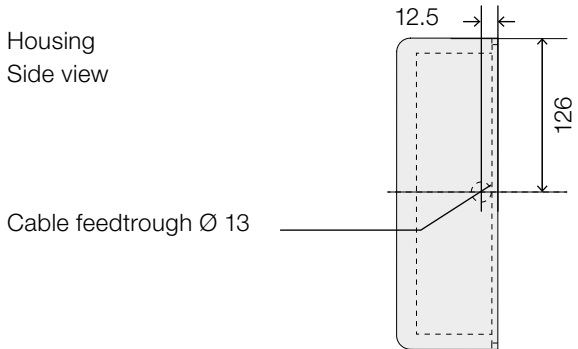

Frequency response | Polar plot

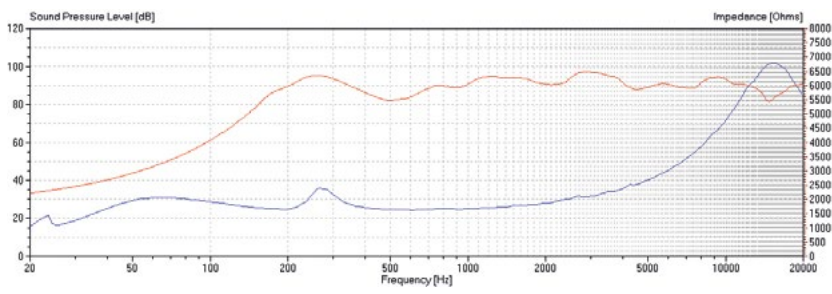

Sensitivity 100 Hz-10 KHz
1/3 Oct. Pink noise total 1 W/4 m

100 Hz	43 dB	125 Hz	49 dB	160 Hz	56 dB
200 Hz	64 dB	250 Hz	69 dB	315 Hz	66 dB
400 Hz	61 dB	500 Hz	57 dB	630 Hz	61 dB
800 Hz	65 dB	1000 Hz	66 dB	1250 Hz	70 dB
1600 Hz	69 dB	2000 Hz	66 dB	2500 Hz	70 dB
3150 Hz	72 dB	4000 Hz	68 dB	5000 Hz	65 dB
6300 Hz	65 dB	8000 Hz	66 dB	10000 Hz	67 dB

