

# GM-5600-EN5424



## Features

- Rectangular cabinet speaker with MDF-wood housing
- 6 W loudspeaker, transformer 100 V
- Prepared cable feedthrough for simple snap and screw mounting
- EN 54-24 Version with ceramic terminal and thermal fuse – no short circuit in case of fire!
- For music and voice reproduction

## Electrical connection

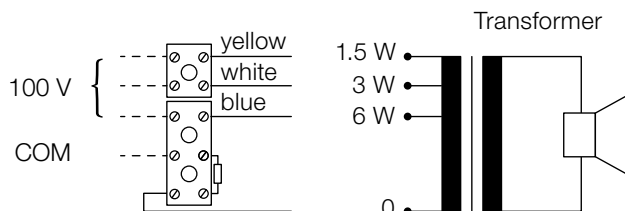

## Specifications

Loudspeaker system	1-way
Nominal noise power 100 V	1.5/3/6W
Nominal impedance 100 V	6667/3333/1667 Ω
Sensitivity (1 W/1 m)	95.7 dB
Sensitivity (1 W/4 m)	79.9 dB
Maximum SPL (6 W/1 m)	103.5 dB
Maximum SPL (6 W/4 m)	87.6 dB
Frequency range (-10 dB)	170–20'000 Hz
Coverage angle (-6 dB)	H 180°/70°/110°/60° V 180°/80°/100°/50°
Magnet	10'500 Gs
Dimensions (W × H × D)	192 × 252 × 82 mm
Material	MDF wood housing
Weight	1.8 kg
Color	White RAL 9003
Temperature range	-20 °C to -45 °C
Protection	IP44
Measurement environment	Half-space free-field

## Certificates

 1438
g+m elektronik ag Buererfeld 12, CH-9245 Oberbüren, Switzerland 14 1438-CPR-0377
EN 54-24:2008 Loudspeaker for voice alarm systems For fire detection and fire alarm systems for buildings Cabinet loudspeaker 6 W and accessories GM-5600-EN5424 Type A

## Ordering information | Accessories

GM-5600-EN5424	Loudspeaker white, EN 54-24
GM-5600-SW-EN5424	Loudspeaker black, EN 54-24
Colors	NCS or RAL available on request

**Dimensions and fitting (in mm)**

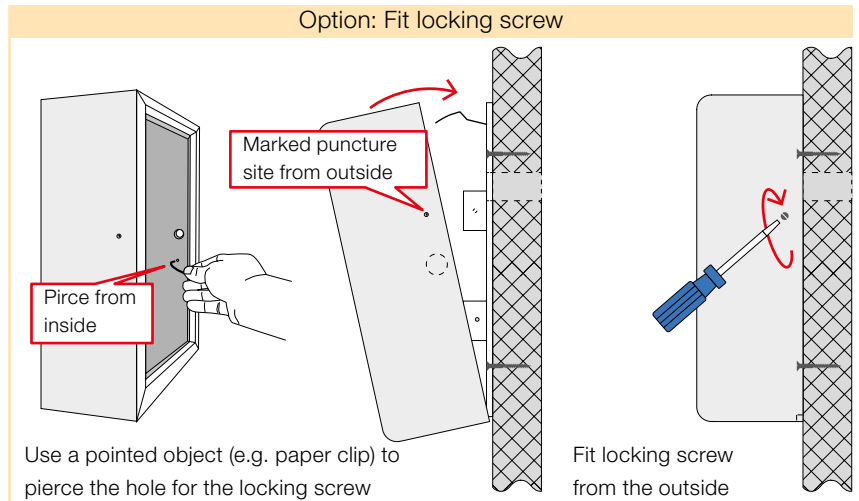
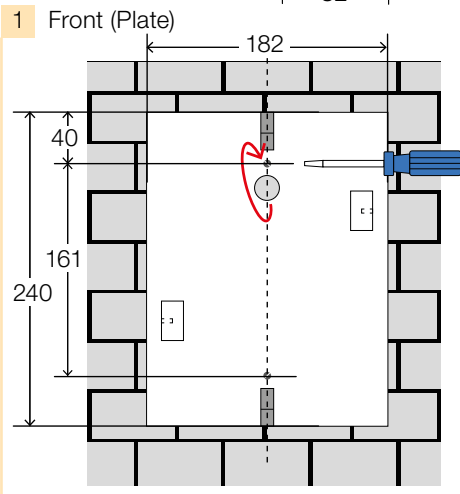
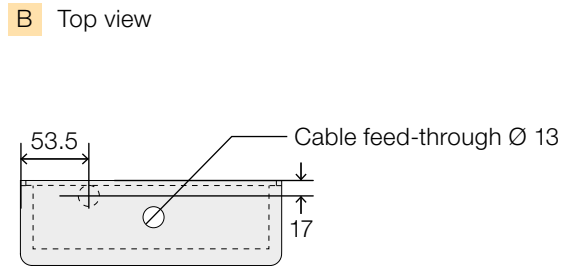
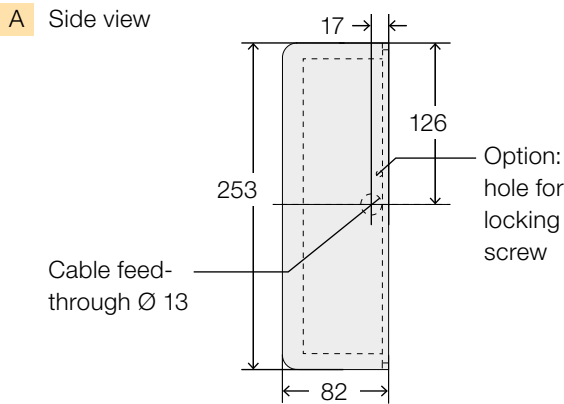

**Frequency response | Polar plot**

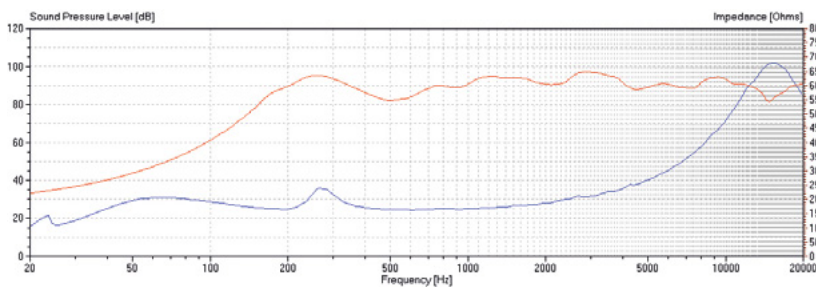

Sensitivity 100 Hz–10 KHz  
1/3 Oct. Pink noise total 1 W/4 m

100 Hz	43 dB	125 Hz	49 dB	160 Hz	56 dB
200 Hz	64 dB	250 Hz	69 dB	315 Hz	66 dB
400 Hz	61 dB	500 Hz	57 dB	630 Hz	61 dB
800 Hz	65 dB	1000 Hz	66 dB	1250 Hz	70 dB
1600 Hz	69 dB	2000 Hz	66 dB	2500 Hz	70 dB
3150 Hz	72 dB	4000 Hz	68 dB	5000 Hz	65 dB
6300 Hz	65 dB	8000 Hz	66 dB	10000 Hz	67 dB

Horizontal

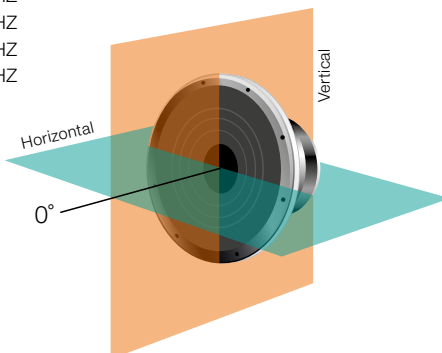
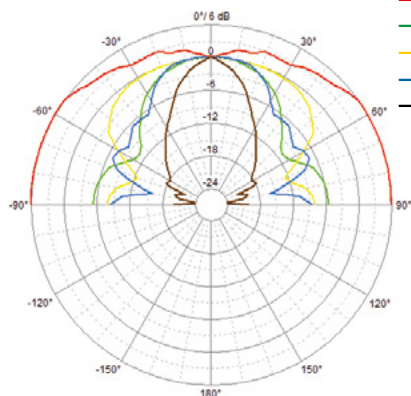

Vertical

